

SPARE PART INSTRUCTION

NR. **1.1.2** NAME **Motor/ Drive wheel**

VERSION **1.0** DATE **15-04-2020** BY **Ruben Roumans**

PAGE
1 of 2

M8 = 18Nm
M6 = 10Nm
M5 = 6Nm
M4 = 4Nm

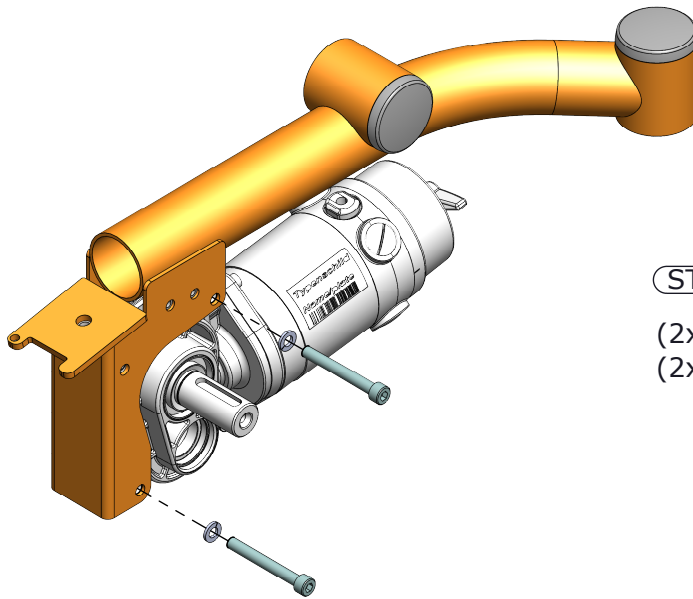

STEP 1

(2x) M8x65
(2x) M8 spring washer

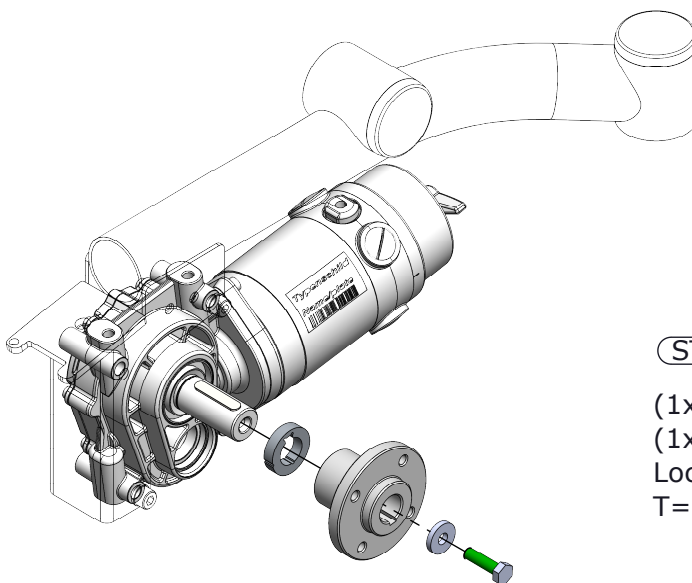

STEP 2

(1x) M8x35 10.9
(1x) M8 washer
Loctite 270
T= 25 NM

SPARE PART INSTRUCTION

NR. **1.1.2** NAME **Motor / Drive wheel**

VERSION **1.0** DATE **15-04-2020** BY **Ruben Roumans**

M8 = 18Nm
M6 = 10Nm
M5 = 6Nm
M4 = 4Nm

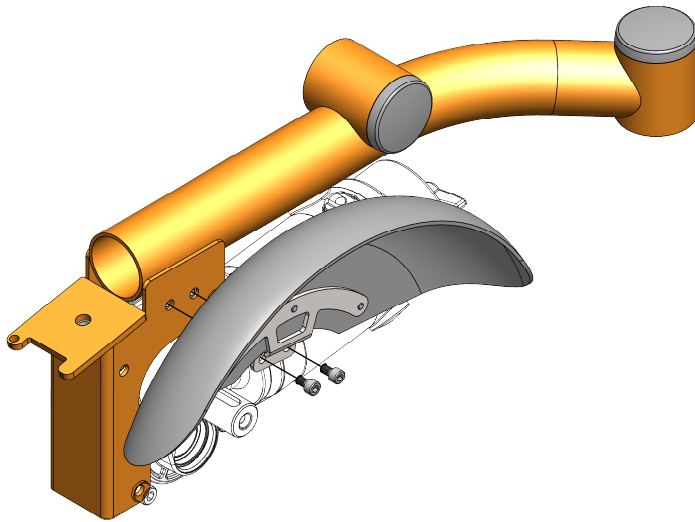

STEP 3

(2x) M6x10

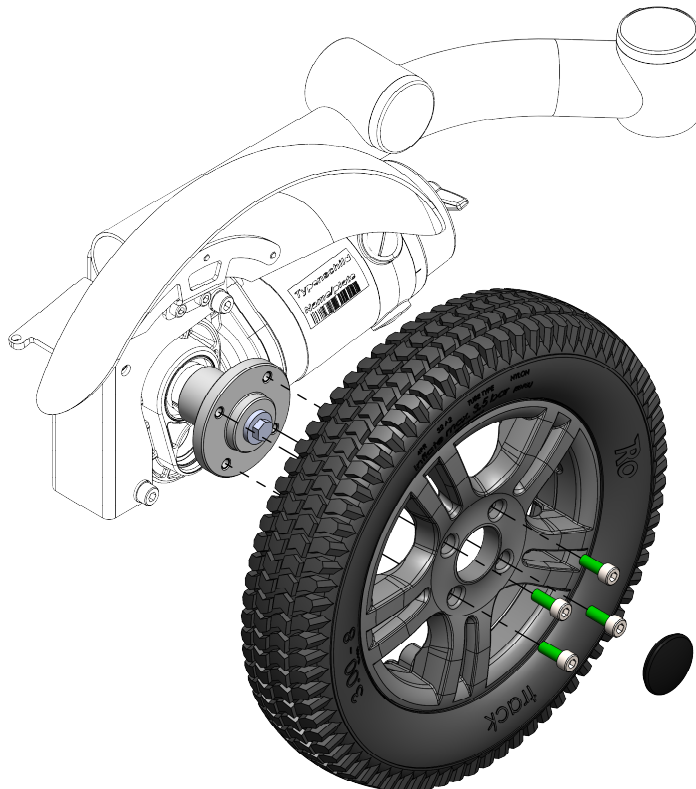

STEP 4  

(4x) M8x20
Loctite 243
T = 18 Nm